

CSP

CSP HYDRAULIC SUPPORT CLAMP (HIGH PRESSURE)

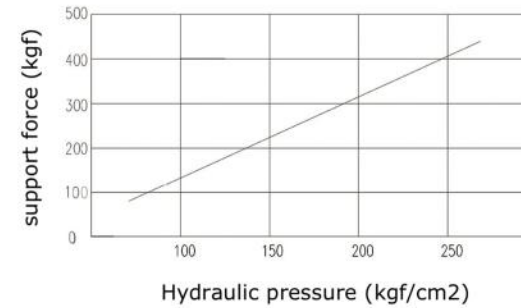

Hydraulic pressure & support force



25MPa Applied force & deformation (um)

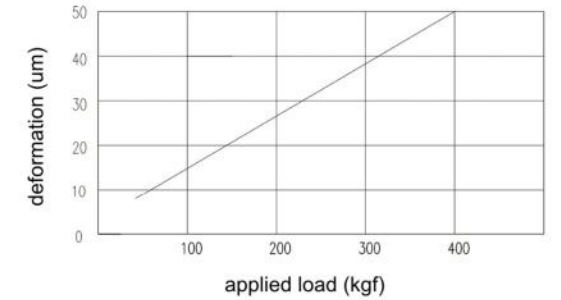

FEATURES

Type A: Supporting with the spring, the spring is used to control a clamping force when the piston rod extends to a highest support position, then clamps the work piece and lock the piston in a supporting condition.

Type B: Supporting with oil pressure, it is operated by means of air pressure and is keeping in a supporting condition when being filled with oil and clamp the work piece.

Max. operating pressure : 70 kgf/cm²

Min. operating pressure : 15 kgf/cm²

Single acting

NOTE

The supporting force must match the clamp force of the swing clamp.

The supporting force at least is equal to 150% of the clamp force of a swing clamp.

Do not exceed the maximum velocity of flow and avoid clamping it too early.

Install the supporting cylinder in the middle place best.

The angle degree between the supporting cylinder and working face could not be larger than 10% while installing.

CSP-16A

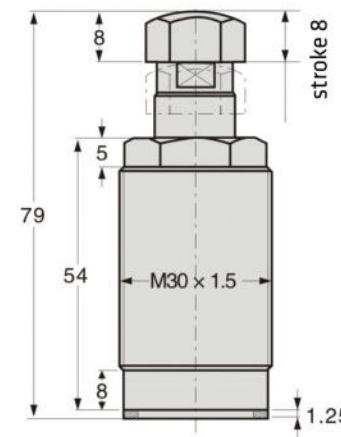

CSP-16B

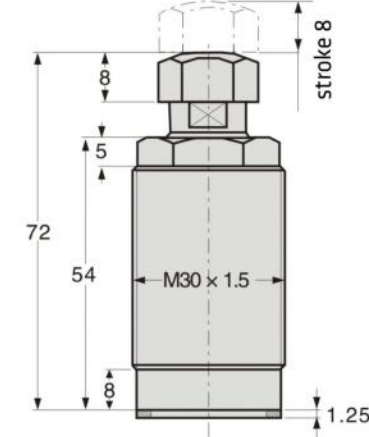

Mounting details

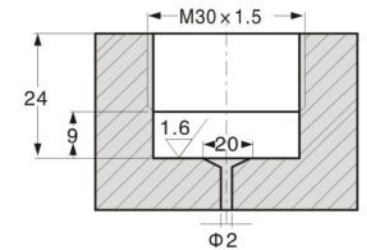

ORDERING INDICATION

CSP-16A

CSP	Series	CSP	
16	Piston rod diameter	Φ16	
A	Type	A:Type A	B:Type B

SPECIFICATION

MODEL	CLAMPING FORCE AT 250 kgf/cm ² (kgf)	CLAMPING FORCE AT 100 kgf/cm ² (kgf)	TOTAL STROKE(mm)	OIL CAPACITY CLAMP(cm ³)	OIL CAPACITY UNCLAMP(cm ³)	USABLE FLUID
CSP-16A	410	140	8	0.60	2.01	General Hydraulic Oil Equivalent to ISO-VG-32
CSP-16B	410	140	8	0.60	2.01	